

WR02H高双圆直线导轨 High double round guide rails



产品特性 Product features

- 铝合金高双圆导轨，硬质氧化表面
 - 配合LIN滑动膜抵抗污物
 - 重量轻和静音
 - 安装简单，免维护
 - 标准安装宽度
- High dual guide rails made of aluminum, Hard anodized surface
 - Resistance to dirt with LIN liners
 - Weight saving and no noise
 - Simple installation, maintenance-free
 - Standard fitting width

标准规格 Standard specifications

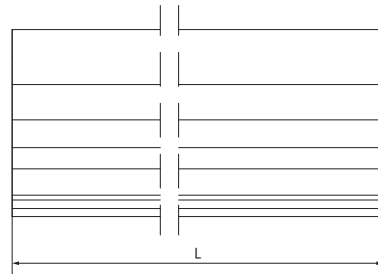
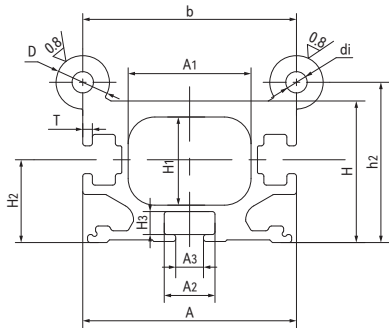

产品编码 Part No.:

WR02H-1040-0000

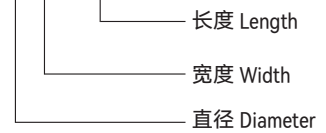

产品编码 Part No.	D [mm]	di [mm]	b [mm]	h ₂ [mm]	A [mm]	A ₁ [mm]	A ₂ [mm]	A ₃ [mm]	H [mm]	H ₁ [mm]	H ₂ [mm]	H ₃ [mm]	T [mm]	L max. [mm]	重量 Weight [kg/m]
WR02H-1040-0000	10	4	40	30	40	23	9.5	5.2	26.5	16.5	15.5	4.3	1.8	3000	2.4